

6

5

4

3

2

1

APPROVED: \_\_\_\_\_

DATE: \_\_\_\_\_ TITLE: \_\_\_\_\_

Rev	AWO #	Description	Date	Appr
-		RELEASED	12/07/10	

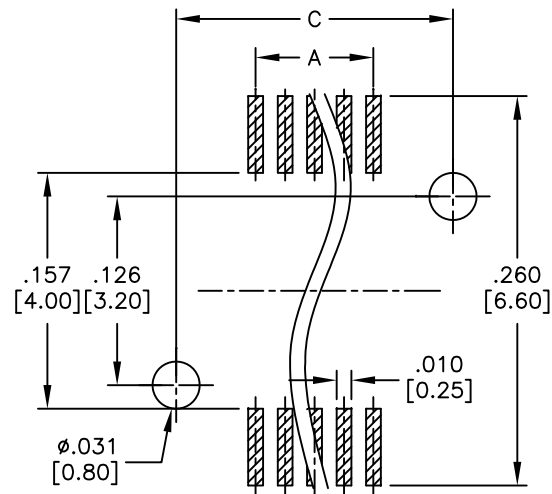
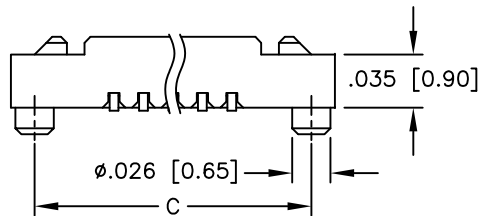
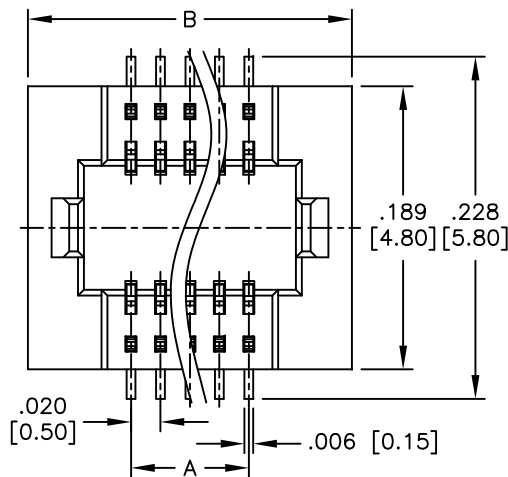

RECOMMENDED PCB LAYOUT

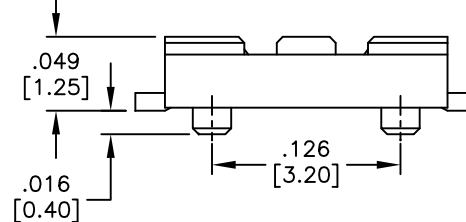

PACKAGED ON TAPE & REEL

SPECIFICATIONS:

Material:  
 Insulator: Hi-temp thermoplastic, rated UL 94V-0  
 Insulator color: Natural  
 Contacts: Copper Alloy  
 Hold down: Copper Alloy  
 Plating:  
 Gold flash over Nickel underplate overall.  
 Electrical:  
 Operating voltage: 50 VAC max  
 Current rating: 0.5 Amps max  
 Contact resistance: 40 mohms max. initial  
 Insulation resistance: 500 Mohms min  
 Environmental:  
 Lead free, RoHS compliant  
 Recommended soldering temp: 260°C for 5 seconds



Positions: 10 thru 60

A = .020 [0.50] x (No. of Contacts per row - 1)  
 B = .020 [0.50] x (No. of Contacts per row - 1) + .138 [3.50]  
 C = .020 [0.50] x (No. of Contacts per row - 1) + .106 [2.70]

UNLESS OTHERWISE SPECIFIED  
 ALL DIMENSIONS ARE INCHES [MM]  
 TOLERANCES: EXCEPT AS NOTED

INCHES		HOLES	
.X	± .10	∅X	± .10
.XX	± .020	∅.XX	± .015
.XXX	± .015	∅.XXX	± .010



TITLE  
 .020 [0.50] BOARD TO BOARD SOCKET, SMT TYPE  
 1.25MM HEIGHT, STACKING HEIGHT=1.5MM

APPROVALS		DATE
DRAWN	DY	12/07/10
CHECKED		
APPROVED		

SIZE X	PART NO. BB5-SE-XX-G-1.25-T/R	REV. -
REF: S00128T	SCALE: NTS	SHEET 1 OF 1

6

5

4

3

2

1