

6

5

4

3

2

1

APPROVED: _____

DATE: _____ TITLE: _____

Rev	AWO #	Description	Date	Appr
-		RELEASED	5/23/05	

D

D

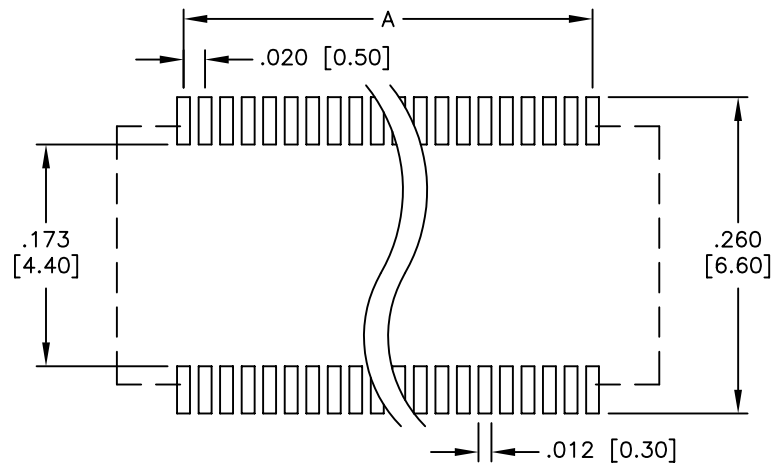
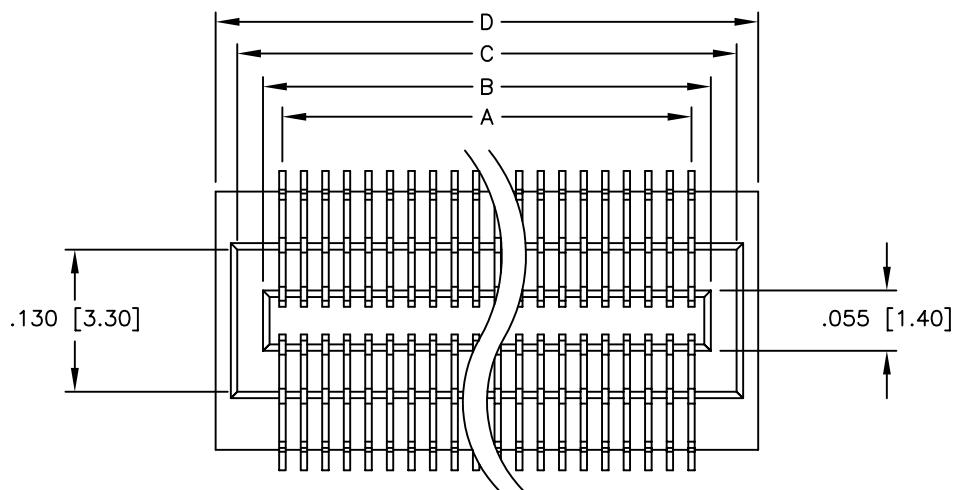

RECOMMENDED PCB LAYOUT

C

C

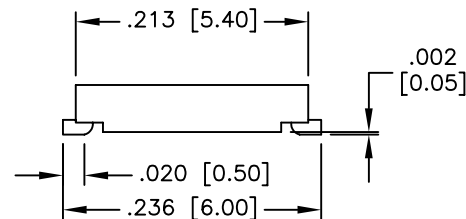
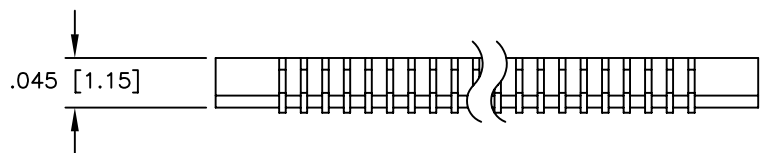

B

B

SPECIFICATIONS:

Material:

Insulator: LCP, glass reinforced, rated UL 94V-0

Insulator color: Natural

Contacts: Phosphor Bronze

Plating:

Gold flash over Nickel underplate overall

Electrical:

Operating voltage: 50 VAC max.

Current rating: 0.3 Amps max.

Contact resistance: 40 mohms max. initial

Insulation resistance: 1,000 Mohms min.

Dielectric withstanding voltage: 500 VAC for 1 minute

Temperature Rating:

Operating temperature: -65°C to +155°C

Environmental:

Lead free, RoHS compliant

Recommended soldering temp: 260°C for 5 seconds



Positions: 20, 28, 30, 40, 50, 60, 70, 80, & 90

A = .020 [0.50] x (No. of Contacts - 1)

B = .020 [0.50] x (No. of Contacts - 1) + .035 [0.90]

C = .020 [0.50] x (No. of Contacts - 1) + .083 [2.10]

D = .020 [0.50] x (No. of Contacts - 1) + .122 [3.10]

A

A

UNLESS OTHERWISE SPECIFIED
 ALL DIMENSIONS ARE INCHES [MM]
 TOLERANCES: EXCEPT AS NOTED

INCHES		HOLES	
.X	± .10	∅X	± .10
.XX	± .020	∅XX	± .015
.XXX	± .015	∅XXX	± .010



APPROVALS		DATE		TITLE	
DRAWN	SS	5/23/05		.020 [0.50] BOARD TO BOARD PLUG SURFACE MOUNT	
CHECKED		SIZE	PART NO.	REV.	
APPROVED		X	BB5-P-XX	-	
REF:			SCALE: NTS	SHEET 1 OF 1	

6

5

4

3

2

1