

APPROVED: \_\_\_\_\_  
 DATE: \_\_\_\_\_ TITLE: \_\_\_\_\_

| Rev | AWO # | Description | Date     | Appr  |
|-----|-------|-------------|----------|-------|
| -   |       | RELEASED    | 10/4/04  |       |
| A   |       | REDRAWN     | 10/22/13 | AV/KW |

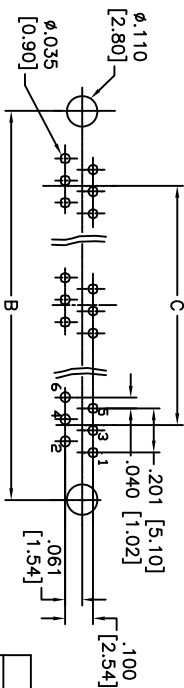
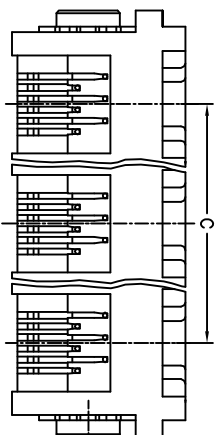
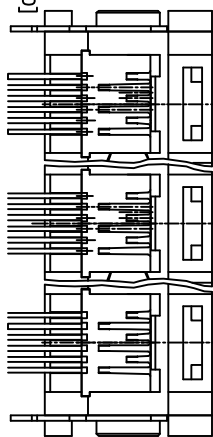
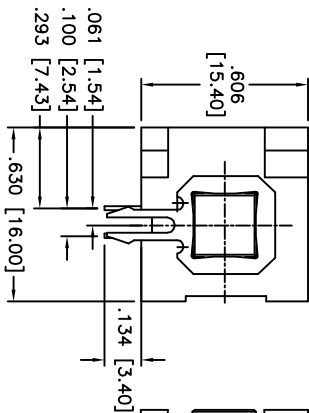
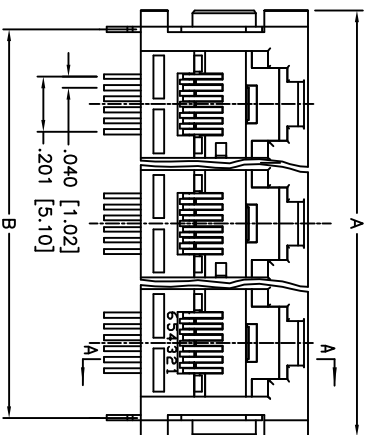
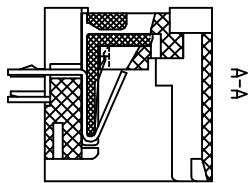

RECOMMENDED PCB LAYOUT

| X | PLATING     |
|---|-------------|
| 0 | 15 µin Gold |
| 1 | 30 µin Gold |
| 2 | 50 µin Gold |

| DIMENSION | No. of Ports     |                  |                  |                  |                  |                  |                  |                   |                   |  |
|-----------|------------------|------------------|------------------|------------------|------------------|------------------|------------------|-------------------|-------------------|--|
|           | 2                | 3                | 4                | 5                | 6                | 7                | 8                | 9                 | 10                |  |
| A         | 1,110<br>[28.20] | 1,543<br>[39.20] | 1,976<br>[50.20] | 2,410<br>[61.20] | 2,842<br>[72.20] | 3,275<br>[83.20] | 3,710<br>[94.20] | 4,142<br>[105.20] | 4,575<br>[116.20] |  |
| B         | 976<br>[24.80]   | 1,409<br>[35.80] | 1,843<br>[46.80] | 2,276<br>[57.80] | 2,709<br>[68.80] | 3,142<br>[79.80] | 3,575<br>[90.80] | 4,008<br>[101.80] | 4,441<br>[112.80] |  |
| C         | 433<br>[11.00]   | 886<br>[22.00]   | 1,299<br>[33.00] | 1,732<br>[44.00] | 2,165<br>[55.00] | 2,598<br>[66.00] | 3,030<br>[77.00] | 3,465<br>[88.00]  | 3,898<br>[99.00]  |  |

**SPECIFICATIONS:**  
**Material:** Insulator: PBT, rated UL 94V-0  
 Insulator color: Gray  
 Contacts: Phosphor Bronze  
 Plating: Gold over Nickel underplate on contact area,  
 Tin over Copper underplate on PCB tails  
**Electrical:**  
 Operating voltage: 125 VAC max  
 Current rating: 1.5 Amps max  
 Contact resistance: 35 mohms max  
 Insulation resistance: 1000 Mohms min @ 500 VDC  
 Dielectric withstanding voltage: 1000 VAC for 1 minute  
 Temperature Rating: Operating temperature: 0°C to +70°C  
**Environmental:**  
 Lead free, RoHS Compliant



TITLE: GANGED MODULAR TELEPHONE JACK, 6P6C  
 RIGHT ANGLE, PCB

|  |              |
|--|--------------|
| UNLESS OTHERWISE SPECIFIED<br>ALL DIMENSIONS ARE INCHES [MM] |              |
| TOLERANCES: EXCEPT AS NOTED                                  |              |
| INCHES   | MM           |
| .X ± .10   | ØXX ± .10    |
| .XX ± .020   | ØXXX ± .015  |
| .XXX ± .015  | ØXXXX ± .010 |
| APPROVALS  | DATE         |
| DRAWN  | SS           |
| CHECKED  |              |
| APPROVED   |              |

|        |               |      |
|--------|---------------|------|
| SIZE   | PART NO.      | REV. |
| X      | MTJG-X-667HX2 | A    |
| REF:   | S00006C       |      |
| SCALE: | NIS           |      |
| SHEET  | 1 OF 1        |      |